

Einbauanleitung Elektrosatz
Anhängervorrichtung mit 12-N Steckdose
lt. DIN/ISO Norm 1724

Instructions de montage du faisceau
électrique pour crochet d'attelage
conforme à la norme
DIN/ISO 1724 prise 12-N

Fitting instructions electric wiringkit
towbar with 12-N socket up to
DIN/ISO norm 1724

Montage-handleiding elektrokabelset voor
trekhaak met 12-N contactdoos
vlgs. DIN/ISO norm 1724

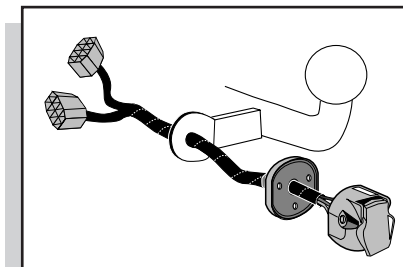

MITSUBISHI COLT / LANCER 1996-

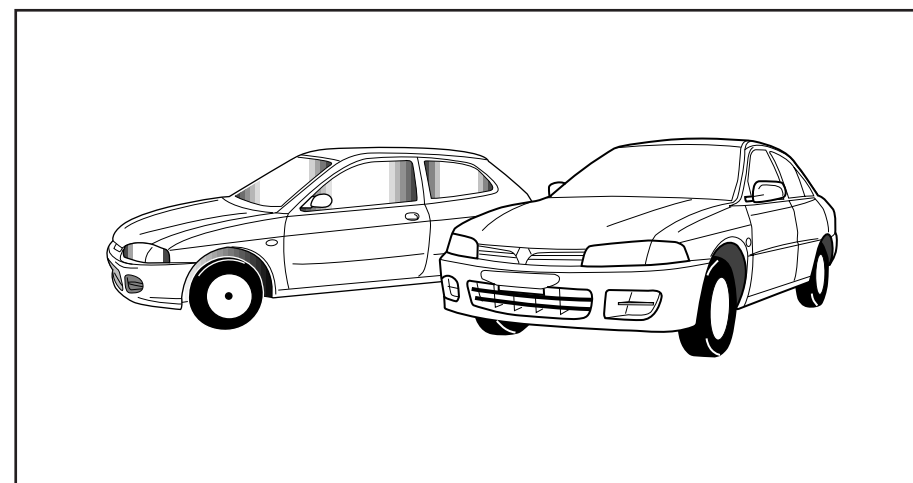

Bestel Nr.: MIT-069-B

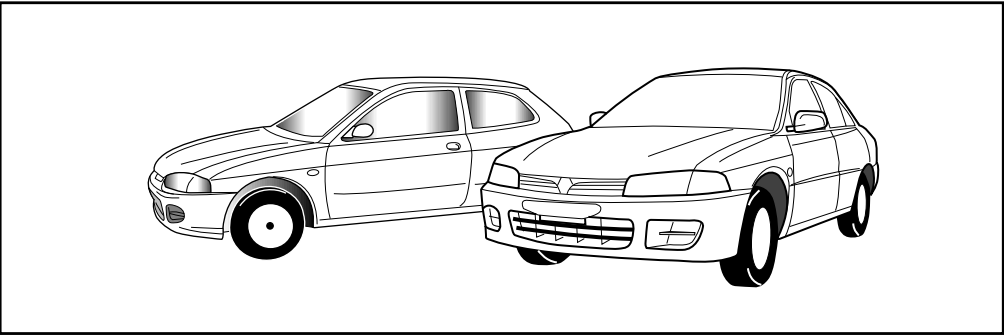

1 Fitting instruction for :
 Einbauanleitung für :
 Instructions de montage pour : **MITSUBISHI COLT,**
 Inbouwhandleiding voor : **LANCER**
 Instrucciones de montaje para :
 Montageanvisning for :

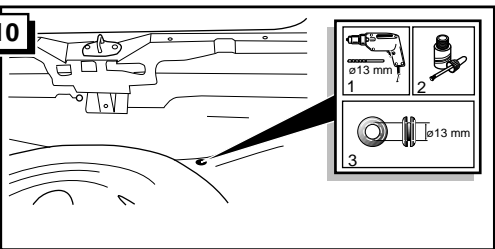
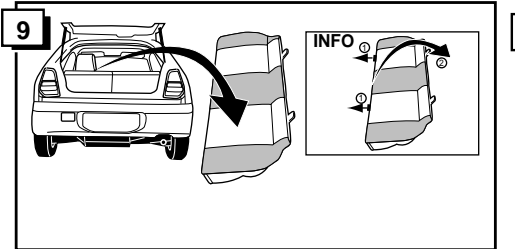
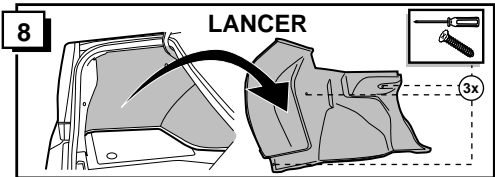
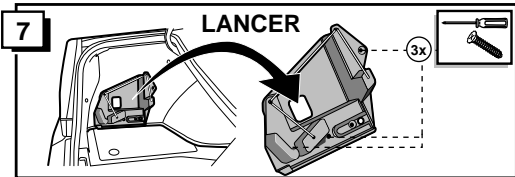
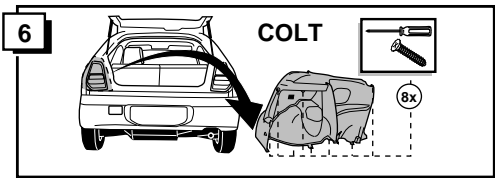
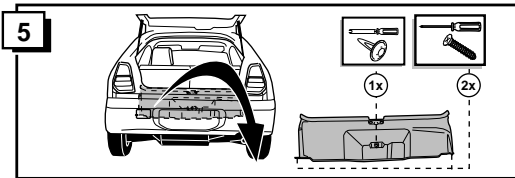
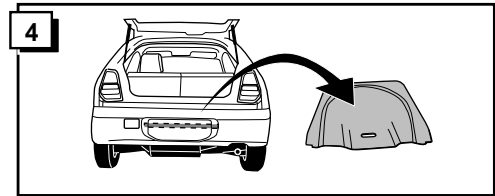
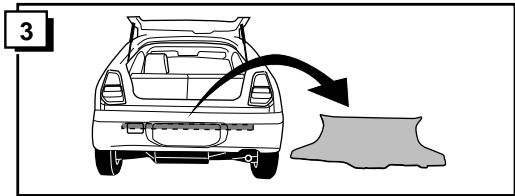
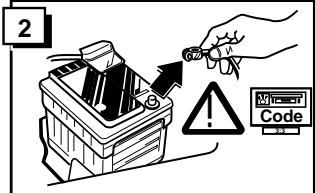

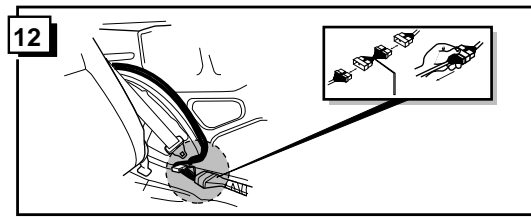
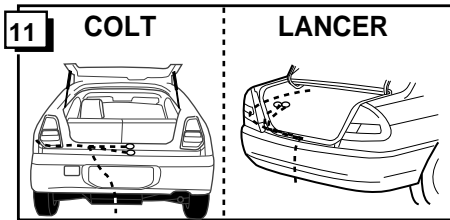

13

KNIPPERLICHT LINKS
 L.H. INDICATOR
 BLINKER LINKS
 CLIGNOTANT GAUCHE
 INTERMITENTE, IZQUIERDA
 BLINKERS VÄNSTER
 MASSA
 EARTH
 MASSE
 MASSA
 JORD

REMLICHTEN
 BRAKELICHTS
 BREMSLEUCHE
 FEUX DE STOP
 LUCES DE FRENADO
 BROMSLIJS

KNIPPERLICHT RECHTS
 R.H. INDICATOR
 BLINKER RECHTS
 CLIGNOTANT DROIT
 INTERMITENTE, DERECHA
 BLINKERS HÖGER

ACHTERLICHT LINKS
 L.H. REARLIGHT
 SCHLUSLEUCHE LINKS
 FEU ARRIERE GAUCHE
 LUZ TRASERA, IZQUIERDA
 BAKLIJS VÄNSTER

ACHTERLICHT RECHTS
 R.H. REARLIGHT
 SCHLUSLEUCHE RECHTS
 FEU ARRIERE DROIT
 LUZ TRASERA, DERECHA
 BAKLIJS HÖGER

	NL	GB	D	F
1 / L	GEEL	YELLOW	GELB	JAUNE
2 / 54-G	BLAUW	BLUE	BLAU	BLEU
3 / 31	WIT	WHITE	WEIß	BLANC
4 / R	GROEN	GREEN	GRÜN	VERT
5 / 58-R	BRUIN	BROWN	BRAUN	MARRON
6 / 54	ROOD	RED	ROT	ROUGE
7 / 58-L	ZWART	BLACK	SCHWARZ	NOIR
8 / 58-B	GRIJS	GREY	GRAU	GRIS

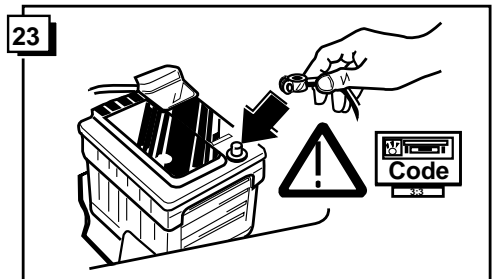
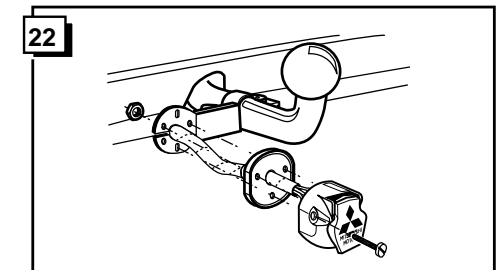
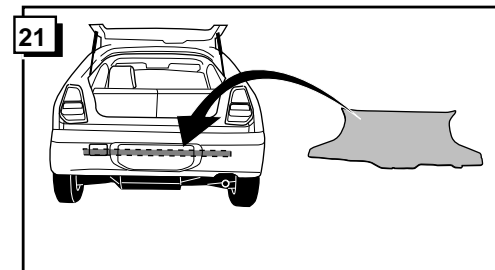
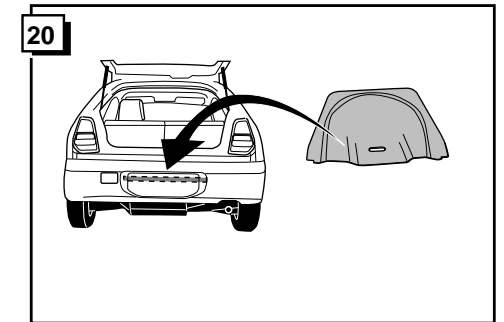
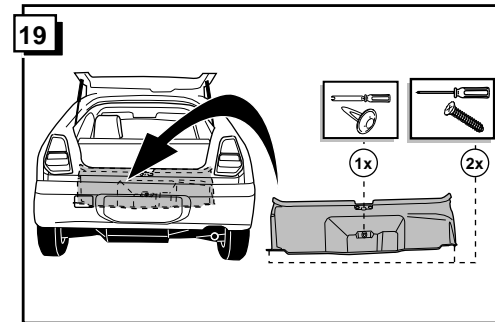
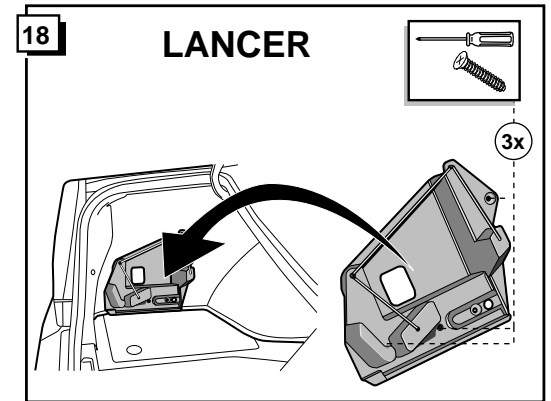
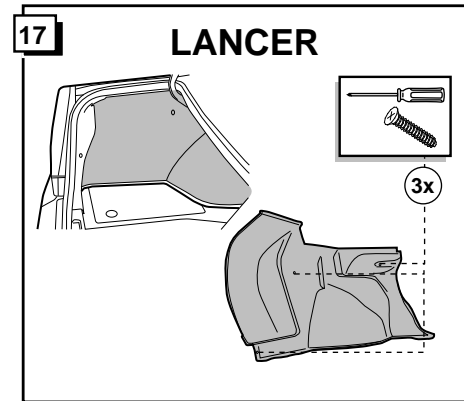
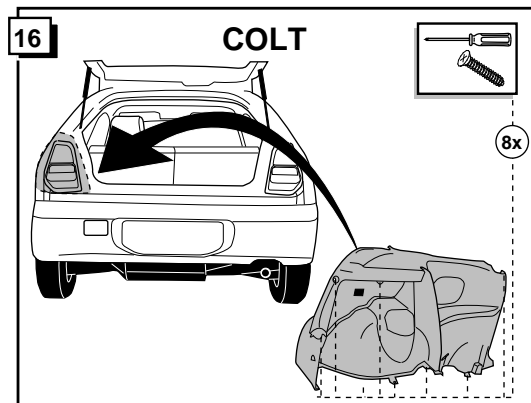
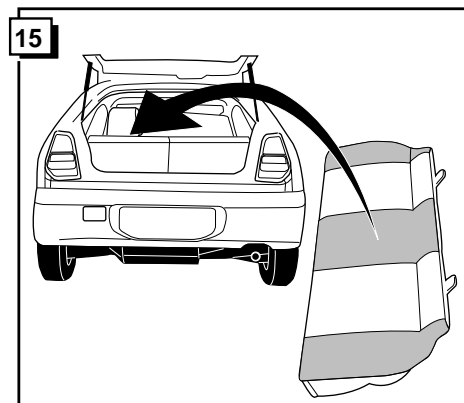
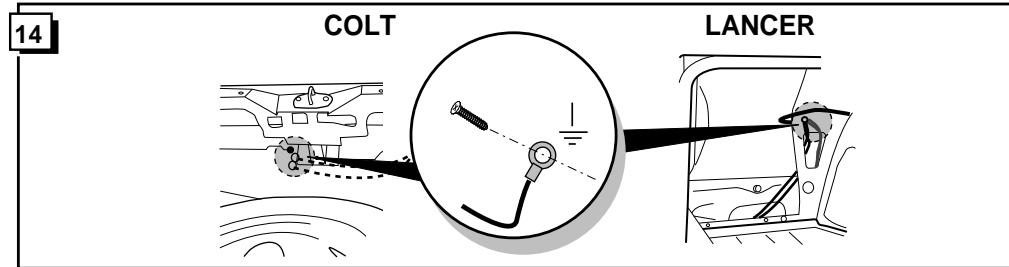

24

CHECK FUNCTIONS !
FUNCTIONEN KONTROLIEREN!
CONTRÔLER LES FONCTIONS!
CONTROLER FUNCTIES!
KONTROLLERA FUNKTIONEN!
CONTROLAR LAS FUNCIONES!